

Rothmans Decal sets application instructions

Application sequence
(valid for TZ01.70.011 and TZ01.70.021):

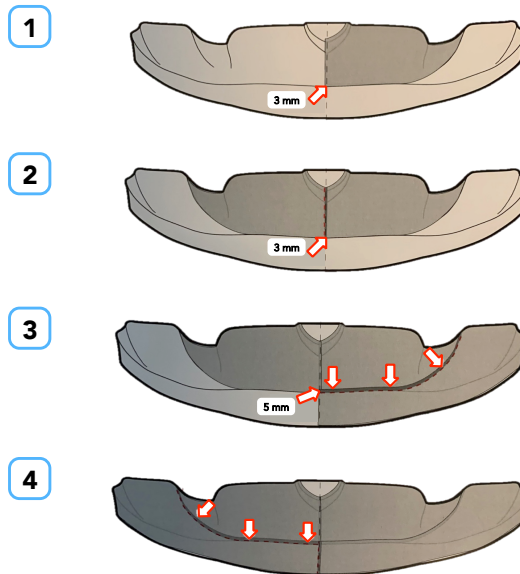

Use a degreasing cleaner to remove any residues and grease traces from your bodywork.
Warm decals and fairing surface with a hair dryer before each decal application



Application sequence
(valid for TZ01.70.012 and TZ01.70.022)

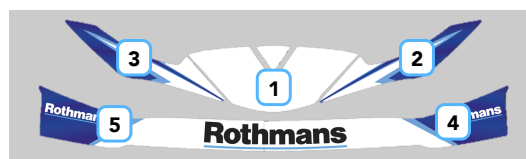

Use a degreasing cleaner to remove any residues and grease traces from your bodywork.
Warm decals and fairing surface with a hair dryer before each decal application

